

Adamson Riva & Lepley
 ARCHITECTS, AIA
 124A NORTH MAIN STREET
 FORKED RIVER, NJ 08731
 TEL: 609 693.9191
 FAX: 609 971.1399
 110 MARTER AVENUE UNIT 303
 MOORESTOWN, NJ 08057
 TEL: 856 222.4652

SCOTT C. LEPLEY, AIA
 N.J. LIC. NO. 21A0163530
 FLAVIO G. RIVA, AIA
 N.J. LIC. NO. 21A0163880
 N.J. LIC. NO. 19A0103500
 JOSEPH F. ADAMSON, AIA
 N.J. LIC. NO. 21A01631700
 N.J. LIC. NO. 28R2

CONSULTANT:

CONSULTANT:

NO.	DATE	DESCRIPTION:
12/22/25	ISSUED FOR PERMIT	

PROJECT: PROPOSED
2 FAMILY HOME
 FOR
CLAM COVE HOLDINGS, LLC
 8200 BEACH AVENUE
 BRIGHTON BEACH, NJ 08008
 LONG BEACH TOWNSHIP, OCEAN COUNTY

PROJECT NO. 2507/8

TITLE:
SECOND FLOOR PLAN

DRAWING:

A2.1

DWG. BY: REM CHKD. BY: SCL

THIS DRAWING SHALL NOT BE USED FOR CONSTRUCTION UNLESS A PROFESSIONAL'S SEAL AND SIGNATURE ARE ON THE DRAWING.

COPYRIGHT © 2025 ADAMSON RIVA & LEPLEY ARCHITECTS

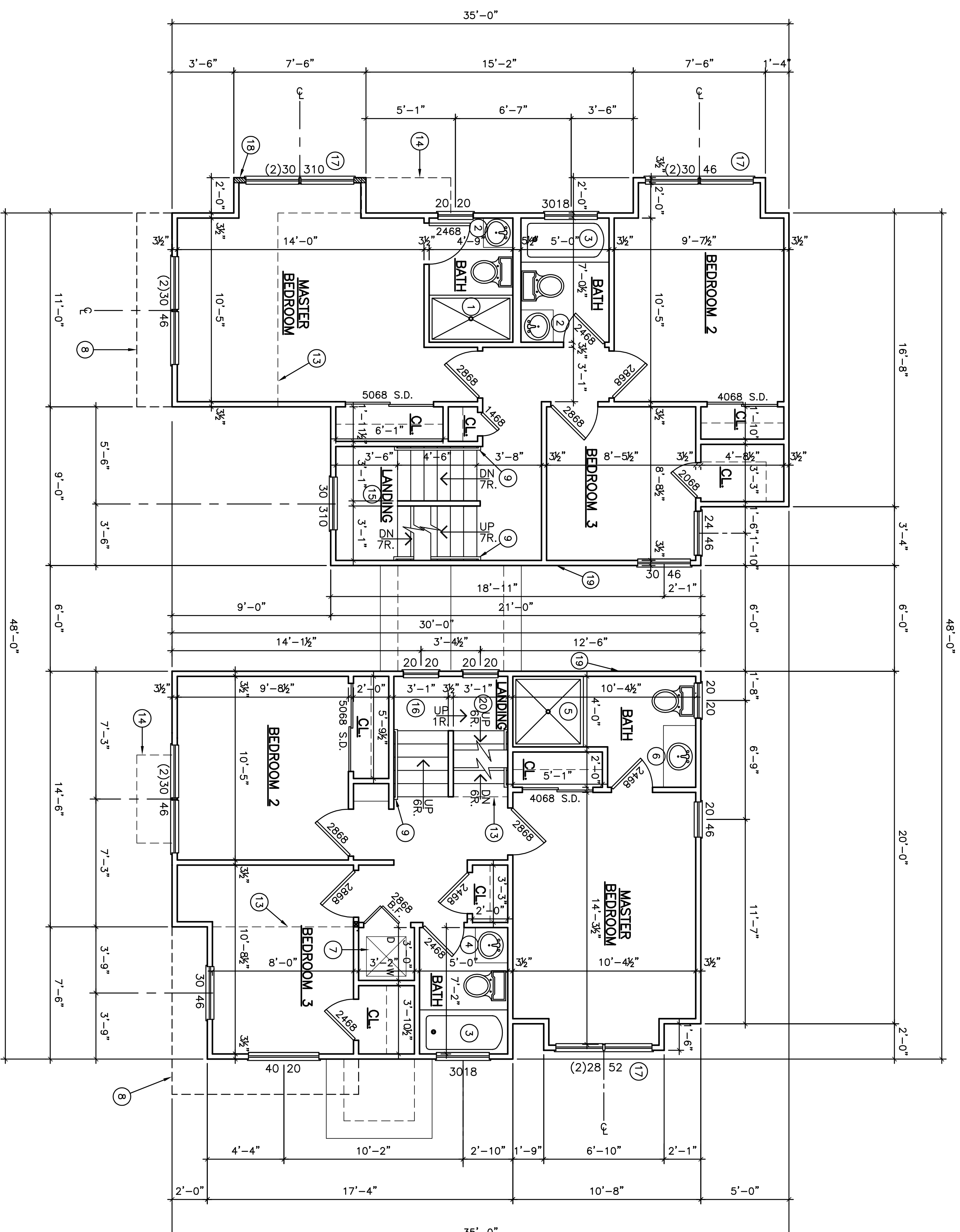

NOTE: 3/4" TYPE "X" GYP. BOARD TAPPED W/(1) COAT OF SPACKLE THROUGHOUT

ANY WINDOW WITH A SILL HEIGHT LESS THAN 24" ABOVE THE FLOOR & GREATER THAN 6'-0" ABOVE THE EXTERIOR WALKING SURFACE SHALL HAVE A CHILD GUARD INSTALLED TO A MIN. HEIGHT OF 24" ABOVE THE FLOOR. THE GUARD SHALL BE INSTALLED PER MANUFACTURER'S INSTRUCTIONS AND BE REMOVED UPON THE INSTALLATION OF THE WINDOW. GUARDS SHALL HAVE MAX. 3/8" CLEAR SPACE.

- 20 SET LANDING 57 1/2" ABOVE R.F.2
- 19 WALLS BETWEEN UNITS A & B TO HAVE 5/8" ONE HOUR FIRE RATED SHEATHING ON EXTERIOR OF COMMON WALLS. SOFFITS TO BE FIRE BLOCKED WITH 2x LUMBER IN ACCORDANCE WITH DETAIL 16 ON SHEET A2.4
- 18 6'-6" PL. HGT
- 17 CANTILEVERED BAY WINDOW
- 16 SET LANDING 49 1/2" ABOVE R.F.2
- 15 SET LANDING 56" ABOVE R.F.1
- 14 LINE OF FIREPLACE ABOVE
- 13 LINE OF THIRD FLOOR ABOVE
- 9 36" HIGH CONT. HANGING STAR HANDRAIL TO BE OF GRASPABLE CONFIGURATION. RETURN RAIL ENDS TO WALL
- 8 LINE OF CANT'D. SUNDECK ABOVE
- 7 VENT APPLIANCES TO EXTERIOR PER MANUFACTURER'S SPECIFICATIONS
- 6 42" VANITY
- 5 48" x 48" SHOWER
- 4 24" VANITY
- 3 32" x 60" TUB/SHOWER COMBINATION
- 2 20" VANITY
- 1 57" x 32" SHOWER

UNIT A LIVING AREA: 632 S.F.
 UNIT B LIVING AREA: 635 S.F.

SECOND FLOOR PLAN

1/4"=1'-0"

05

KEYED NOTES

01